



Los Angeles Religious Education Congress  
 Anaheim Convention Center  
 March 23rd. - 25th. 2012

OFFICIAL AUDIO VIDEO CONTRACTOR  
**AUDIO VIDEO & COMPUTER RENTAL FORM**

Advanced Show Rate Apply Before March 13th. 2012

| HI DEF LCD 1080p   |   | Qty | Advanced Rate | Show Rate  | Totals |
|--|---|-----|---------------|------------|--------|
| 32" HD LCD Sharp 1080p Video & PC                          |    |     | \$350.00      | \$450.00   |        |
| 42" HD LCD Sharp 1080p Video & PC                          |   |     | \$450.00      | \$550.00   |        |
| 46" HD LCD Sharp 1080p Video & PC                          |   |     | \$550.00      | \$650.00   |        |
| 52" HD LCD Sharp 1080p Video & PC                          |   |     | \$650.00      | \$750.00   |        |
| 70" HD LCD Sharp 1080p Video & PC                          |   |     | \$950.00      | \$1,050.00 |        |
| Duel Post Monitor Stand                                    |   |     | \$75.00       | \$100.00   |        |
| LCD Monitor  |   | Qty | Advanced Rate | Show Rate  | Totals |
| 17" LCD Monitor  |    |     | \$100.00      | \$150.00   |        |
| 20" LCD Monitor  |   |     | \$200.00      | \$250.00   |        |
| 23" LCD Monitor  |   |     | \$250.00      | \$300.00   |        |
| PLASMA DISPLAY (include Table Top stand and Wall Mount)    |   | Qty | Advanced Rate | Show Rate  | Totals |
| 42" Plasma Display   |   |     | \$400.00      | \$500.00   |        |
| 50" Plasma Display   |   |     | \$600.00      | \$700.00   |        |
| Speakers for Plasma  |   |     | \$50.00       | \$75.00    |        |
| Duel Post Monitor Stand                                    |   |     | \$75.00       | \$100.00   |        |
| VIDEO MONITORS   |   | Qty | Advanced Rate | Show Rate  | Totals |
| 20" Video Monitor/VHS Combo Unit                           |  |     | \$75.00       | \$125.00   |        |
| 27" Video Monitor (NOT FOR COMPUTER USE)                   |   |     | \$175.00      | \$225.00   |        |
| 32" Video Monitor (NOT FOR COMPUTER USE)                   |   |     | \$250.00      | \$300.00   |        |
| AUDIO EQUIPMENT  |   | Qty | Advanced Rate | Show Rate  | Totals |
| UHF Wireless Combo:( ) Hand Held ( ) Head Set ( ) Lavalier |  |     | \$225.00      | \$275.00   |        |
| Anchor Explorer speaker: 60 watts                          |   |     | \$100.00      | \$150.00   |        |
| JBL 10 Professional speaker: 125 watts                     |   |     | \$150.00      | \$200.00   |        |
| JBL 15 Professional speaker: 300 watts                     |   |     | \$225.00      | \$275.00   |        |
| EV SX300 Speaker 300 watts                                 |   |     | \$275.00      | \$325.00   |        |
| 12 Channel Mixer   |   |     | \$75.00       | \$100.00   |        |
| DATA VIDEO INTERFACE                                       |   | Qty | Advanced Rate | Show Rate  | Totals |
| Video Distribution Amplifier ( 1 x 6 )                     |  |     | \$75.00       | \$100.00   |        |
| VGA Distribution Amplifier ( 1 x 2 )                       |   |     | \$50.00       | \$75.00    |        |
| VGA Switcher ( 4 x 1)                                      |   |     | \$25.00       | \$50.00    |        |
| DVD/ VCR Combo   |   |     | \$50.00       | \$75.00    |        |
| DVD ( ) or VCR ( )   |   |     | \$50.00       | \$75.00    |        |
| DVD Recorder   |   |     | \$75.00       | \$100.00   |        |
| Scan Converter Sony 1024 HD                                |   |     | \$300.00      | \$350.00   |        |
| Folsom Presentation Pro                                    |   |     | \$450.00      | \$500.00   |        |



# Audio Visual Order Form

| PC/ MAC COMPUTER EQUIPMENT/ W 15" Monitor              | Qty | Advanced Rate | Show Rate | Totals |
|--|-----|---------------|-----------|--------|
| iMac computer  |     | \$275.00      | \$325.00  |        |
| Laptop Dual Core 2.0Ghz 2GB Ram 100 Gig HD DVD         |     | \$175.00      | \$225.00  |        |
| Projector Screens                                      | Qty | Advanced Rate | Show Rate | Totals |
| Projector Hitachi CP X400 3000 Lumens 8 Lbs            |     | \$350.00      | \$400.00  |        |
| Tripod Screen ( ) 6', ( ) 7' or ( ) 8'                 |     | \$75.00       | \$100.00  |        |
| Lighting packages and other equipment (call for quote) |     |               |           |        |

Other Gear Available upon Request

Video Wall



Lighting

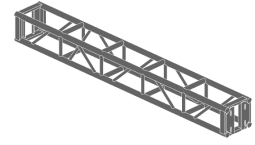

| IMPORTANT INFORMATION  | ORDER SUMMARY            | TOTALS |
|--|--------------------------|--------|
| Payment : Show Gear Productions requires pre payment on all orders.        | Equipment Charges        |        |
| Delivery/Labor/Set-up Charge 20% of equipment total (\$50 Minimum Charge)  | 50.00 Min or             |        |
|  | 20% of Total Rented Gear |        |
| Facility, Drayage & Forced Union fees if applicable are not included       |                          |        |
| Requested delivery times are subject to change based on drayage schedules. | <b>GRAND TOTAL</b>       |        |

### TERMS and Conditions

**CANCELLATIONS:** Written cancellation of ordered equipment must be received 72 hours prior to delivery. Failure to do so will result in a 50% charge. On site cancellation, 100% of original charges will be applied.

Customer agrees to be liable for replacement cost of damaged or missing equipment

### OPERATIONAL LABOR

Labor, if required, is subject to prevailing rate at \$50.00 an hour with a 4 hour minimum (call for OT/DBL rates).

| COMPANY INFORMATION  |  | Method of Payment                                |      |
|--|--|--|------|
| Company name   |  | Type of Card                                     |      |
| Address  |  | Credit Card #                                    |      |
| City, State, Zip   |  | Exp.   | Name |
| Phone Number   |  | Billing Address                                  |      |
| Fax Number   |  | City, State, Zip                                 |      |
| By signing below, you agree to allow SGP to use the indicated credit card number for all audio visual charges for this event |  |  |      |
| Email  |  | Authorized Signature                             |      |
| TRADE SHOW INFORMATION   |  |  |      |
| Delivery Date and Time:  |  | Pick Up Date and Time:                           |      |
| Booth # and Hall:  |  | On-Site Contact name and Number (Fill out below) |      |
| Order Comments:  |  |  |      |

Inventory is updated regularly. If you do not see what you are looking for please call.

Show Gear Productions 30312 Esperanza Rancho Santa Margarita, CA 92688

[david@showgear.com](mailto:david@showgear.com) 800 840-4327 Cell 949 283-7231

**FAX ORDER TO 949 888-4881**

